

Quick Start Guide

AgaMatrix WaveSense JAZZ™ Wireless Blood Glucose Monitoring System



AUTOMATICALLY SYNCs TO APP VIA Bluetooth® wireless technology

Reference steps on the reverse side to pair and sync.

Replacement Batteries are Included!

Two replacement CR2032, 3-volt, lithium batteries are included in your meter's carrying case. Reference the battery replacement instructions on the reverse side.

Customer Care: 0800 093 1812 or 01235 838588*

In case of emergency, contact your healthcare professional or emergency medical response.



About the System

The AgaMatrix WaveSense JAZZ Wireless Blood Glucose Monitoring System allows you to check your glucose levels with capillary whole blood. For complete instructions, see your AgaMatrix WaveSense JAZZ Wireless Owner's Guide.

WARNING: The AgaMatrix Lancing Device **MUST** be used **ONLY** to obtain a blood sample by a single person for self-testing. Do not use any lancet or lancing device that has been used by another person.

Blood Glucose Meter

- 1) Display Area
- 2) Test Strip Port
- 3) Meter Button: Press to turn on the meter and view past glucose test results.



Test Strip

- 1) Contact Bars: insert this end into the test strip port
- 2) Visual Fill Window: completely fills when enough sample is applied
- 3) Sample Area: blood or control solution applied here



Lancing System

- 1) Cocking Handle
- 2) Depth Adjustment Dial
- 3) Depth Indicator Window
- 4) Release Button
- 5) Lancet Holder Cup
- 6) Lancing Device Cap
- 7) Lancet
- 8) Lancet Cover

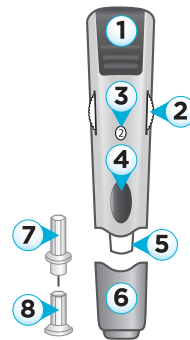

Note: You should sync your meter to the AgaMatrix Diabetes Manager App (the App) to set the meter's time and date before testing. This will ensure that results from meter are sent wirelessly to the App. Reference the reverse side of this Quick Start Guide or see your Owner's Guide for further details.

Blood Glucose Testing Steps

(For complete instructions, see your AgaMatrix WaveSense JAZZ Wireless Owner's Guide)

1 Insert the test strip into the meter:

Insert the test strip, with the contact bars facing up, into the test strip port. The meter will automatically be activated.

CAUTION: To ensure accurate results, wash your hands with warm, soapy water, rinse and thoroughly dry before every test.

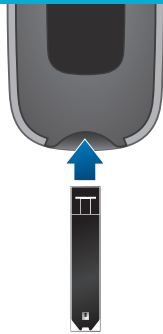

2 Lance the test site:

Reference the instructions for how to prepare the lancing device, on the right.

Press the lancing device against the site to be lanced and press the release button.

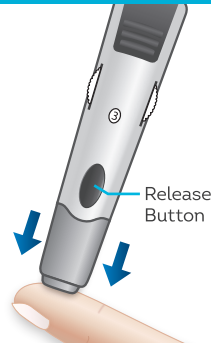

3 Obtain a drop of blood:

Squeeze from the base of your finger up towards the tip, milking your finger, until a small blood drop forms.

Do not squeeze directly around the lanced area.

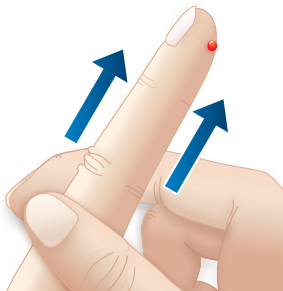

4 Bring the test strip to the blood sample:

The meter displays the apply sample to test strip animation, indicating it is now ready for you to apply blood.

The test strip draws the blood into the test strip through the sample area.

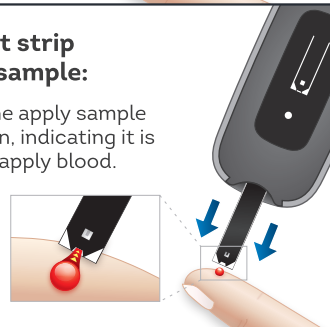

5 Remove from sample when the test strip's visual fill window completely turns red and meter beeps:

The sample applied symbol will appear on the meter's screen and the meter will beep when you should remove the test strip from the blood sample.

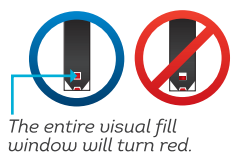

The calculating animation will appear on the meter's display as it is calculating the test result.



6 View test result and final steps:

Following the calculation animation, the test result will appear on the meter display. The test result is stored in the meter's memory.

Remove the used test strip from the meter. The meter will automatically turn off.

Snap off the lancing device cap and replace lancet cover. Remove the used lancet.

Discard the used test strip and lancet properly. Follow your healthcare professional's instructions for disposal.



Prepare the Lancing System

- 1 Snap off the cap from the lancing device.

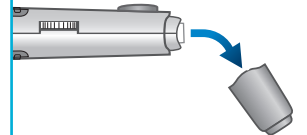

- 2 Insert a new lancet firmly into the lancet holder cup.



- 3 Twist the lancet cover off.

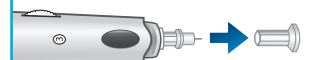

- 4 Replace lancing device cap.

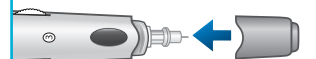

- 5 Set the lancing level.



- 6 Pull the cocking handle out until it clicks.



Quick Start Guide

AgaMatrix WaveSense JAZZ™ Wireless Blood Glucose Monitoring System



AUTOMATICALLY SYNCs TO APP VIA Bluetooth® wireless technology

Note: You should sync your meter to the AgaMatrix Diabetes Manager App (the App) to set the meter's time and date before testing. This will ensure that results from meter are sent wirelessly to the App.

BATTERY REPLACEMENT INSTRUCTIONS

IMPORTANT: Only use CR2032 or DL2032 batteries with the AgaMatrix WaveSense JAZZ Wireless Meter.

Battery Display Messages



Low Battery Message: (This message appears for 2 seconds) You can still perform a test when you see a low battery message, but batteries should be replaced as soon as possible. Use only CR2032 or DL2032 batteries.



Dead Battery Message: The batteries in your meter do not have enough power to activate your meter and perform a test; batteries must be replaced.

Replacing the Batteries (For more details, see your AgaMatrix WaveSense JAZZ Wireless Owner's Guide)

IMPORTANT: When the batteries are replaced, the time and date will be erased from your meter. You must sync your meter with your supported device to ensure your readings have time and date. To sync your meter, reference the instructions on the right.

Note: Removing the batteries does not affect stored glucose records.

1 Open the battery door:

Make sure the meter is off. Turn the meter so you are looking at the battery door. Slide the battery door off the meter.



2 Remove the used batteries:

Remove the used batteries with a non metallic tool.

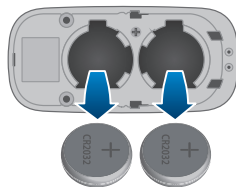

Used Batteries

3 Install the new batteries:

Two replacement batteries are included in the pocket of your meter's carrying case. Locate the replacement batteries.

Install the new batteries with the positive (+) sign facing up towards you.

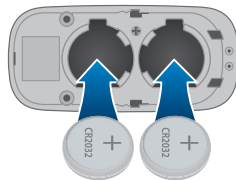

New Batteries

4 Close the battery door:

Slide the battery door onto the meter. Make sure that the battery door is completely closed before using the meter.

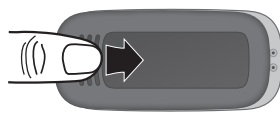

Please dispose of used batteries according to your local environmental regulations.

PAIRING & SYNCING INSTRUCTIONS

The AgaMatrix Diabetes Manager App works on a variety of iOS and Android™ devices visit www.agamatrix.co.uk for an updated list.

Pairing and Syncing Your Meter With the App

Use the AgaMatrix WaveSense JAZZ Wireless Meter with the AgaMatrix Diabetes Manager App (the App) to sync glucose results directly to your iOS or Android device.

You should sync your meter to the AgaMatrix Diabetes Manager App (the App) to set your meter's time and date before testing. This will ensure that results from meter are sent wirelessly to the App on your supported device.

1 Download and open the App:

Download the AgaMatrix Diabetes Manager App (the App) from the App Store™ (for Apple devices) or from Google Play™ (for Android devices).



Tap on the App icon on your supported device.

2 Navigate to the menu icon:

Tap on the icon made of three lines.

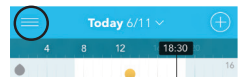

3 Add a new meter:

Tap on "Meters." Tap "Add a new meter."

On your meter, press and hold the Meter Button. Select your meter when it appears in the app.

4 Enter the passkey:

A 6-digit passkey will appear on the meter. Type the passkey number into the App.

Example of a passkey:



5 Confirm pairing is successful:

Both the meter and the App will indicate that pairing was successful. The meter will have a check symbol and the App will show a message.

Example of check symbol:



6 Sync data:

After your meter is paired with your device, it will "sync", or transfer data, every time it is within close proximity of your paired device.

Note: The meter and App must be within 10 meters of each other in order to pair and transfer data.

7 Pairing additional devices:

You can pair your meter with up to 8 supported devices. Follow the above steps for each device you want to sync with your meter.

WARNING: Do not pair the meter with an App on a device used by another person. Data synced from the meter cannot be deleted from the App. If you pair with another person's meter, the data from each meter will be combined in the App and may give you incorrect reports.



AgaMatrix, Inc. 7C Raymond Ave
Salem, NH 03079 USA



MDS5 GmbH, Schiffgraben 41
30175 Hannover, Germany

The Bluetooth® word mark and logos are owned by the Bluetooth® SIG, Inc. and any use of such marks by AgaMatrix, Inc. is under license. Other trademarks and trade names are those of their respective owners. Apple and the Apple logo are trademarks of Apple Inc., registered in the U.S. and other countries. App Store is a service mark of Apple Inc. Android is a trademark of Google Inc. Google Play is a trademark of Google Inc.